

Parts and Accessories Diagram

HMD200

PROPRIETARY RIGHTS NOTICE This document and all information contained within it is the property of Hamilton Beach Brands, Inc. (HBB). It is confidential and proprietary and has been provided to you for a limited purpose. It must be returned or destroyed upon request. Disclosure, reproduction or use of this document and any information contained within it, in full or in part, for any purpose is forbidden without the prior written consent of HBB. No photographs may be taken of any article fabricated or assembled from this document without the prior written consent of HBB.

Replacement Parts

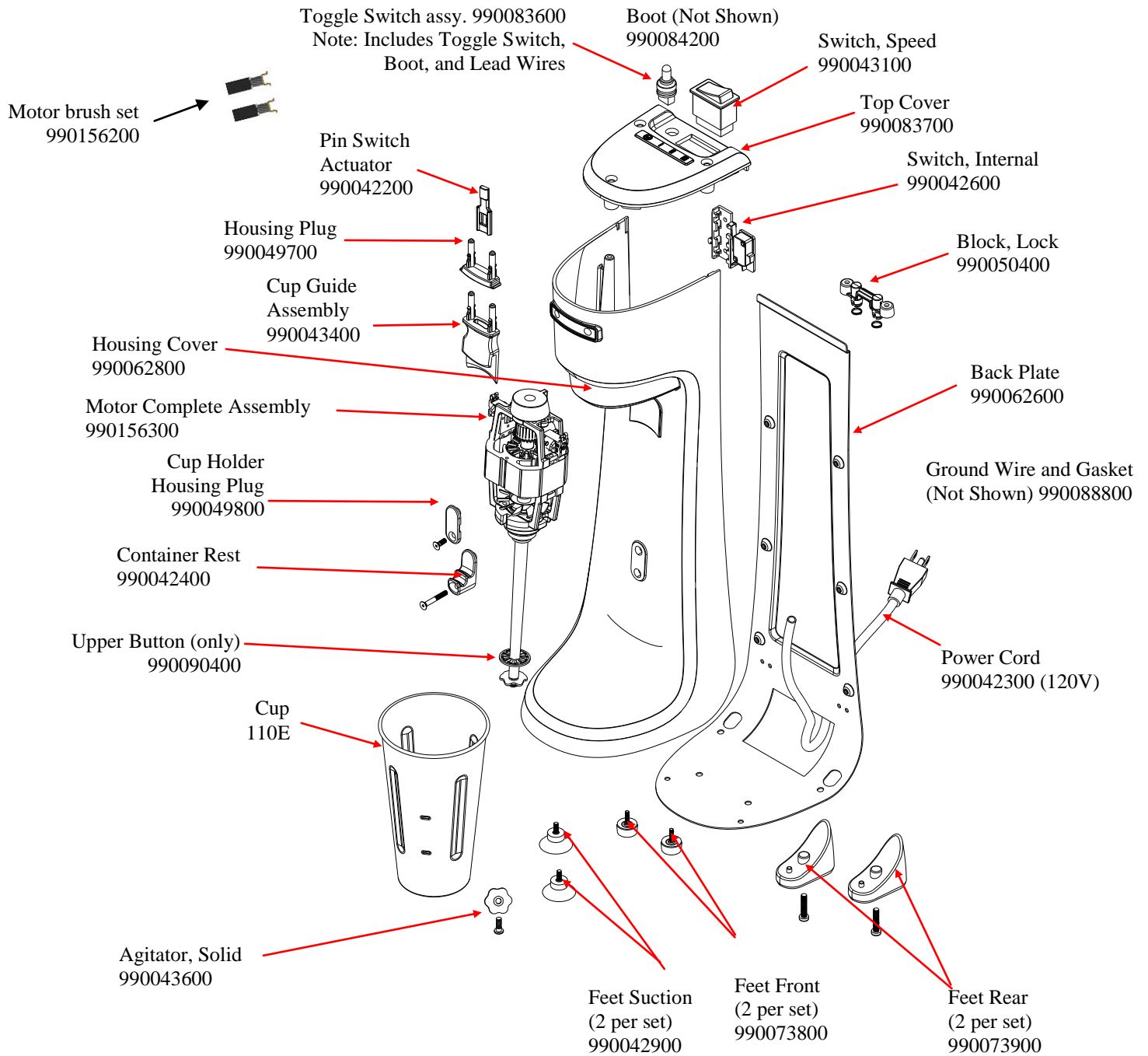

Switch Upgrade Kit (series A-D) – 990092800
Includes: Top Cover, Toggle Switch, Boot, Grounding Wire, and Switch Adaptor.

Switch Adaptor (Not Shown) 990088900

 Hamilton Beach 4421 Waterfront Drive Glen Allen, VA 23060	Revision Description:	Revised Cup Holder to Container Rest					
	Request Number:	DOC4461	Revision Date:	2/7/14	Approved by:	DOC4461	
	Issue Code(s):	L	Page:	1 of 2	Document #:	540006500	Rev:

Accessories

HMD200

PROPRIETARY RIGHTS NOTICE This document and all information contained within it is the property of Hamilton Beach Brands, Inc. (HBB). It is confidential and proprietary and has been provided to you for a limited purpose. It must be returned or destroyed upon request. Disclosure, reproduction or use of this document and any information contained within it, in full or in part, for any purpose is forbidden without the prior written consent of HBB. No photographs may be taken of any article fabricated or assembled from this document without the prior written consent of HBB.

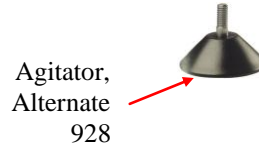
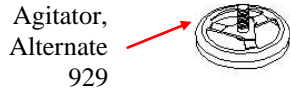

 4421 Waterfront Drive Glen Allen, VA 23060	Revision Description:	Revised Cup Holder to Container Rest						
	Request Number:	DOC4461	Revision Date:	2/7/14	Approved by:	DOC4461		
	Issue Code(s):	L	Page:	2 of 2	Document #:	540006500	Rev:	C