

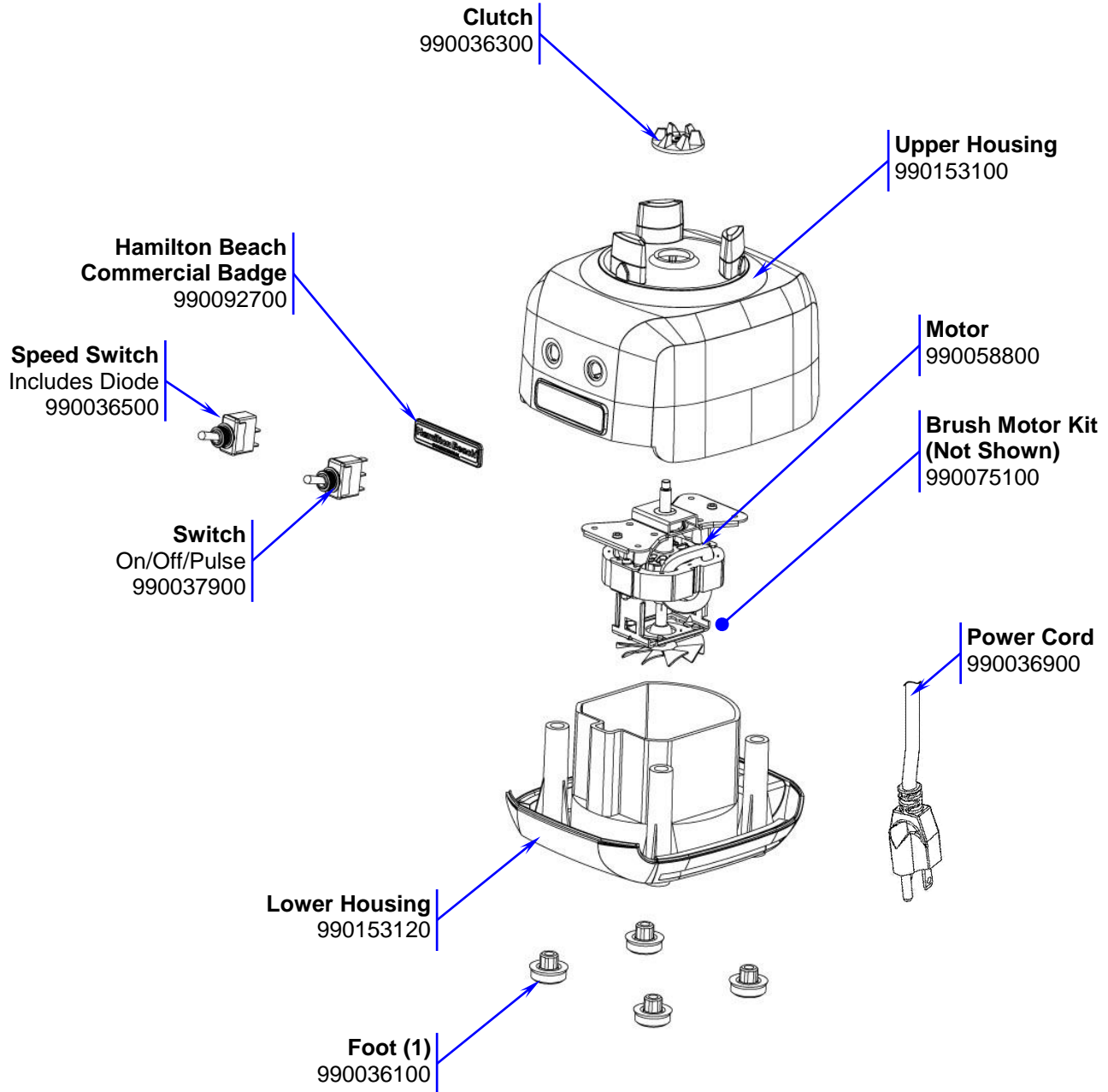

## Parts and Accessories Diagram

### Model HBB250R

**PROPRIETARY RIGHTS NOTICE** This document and all information contained within it is the property of Hamilton Beach Brands, Inc. (HBB). It is confidential and proprietary and has been provided to you for a limited purpose. It must be returned or destroyed upon request. Disclosure, reproduction or use of this document and any information contained within it, in full or in part, for any purpose is forbidden without the prior written consent of HBB. No photographs may be taken of any article fabricated or assembled from this document without the prior written consent of HBB.

## Replacement Parts





 <p>Hamilton Beach 4421 Waterfront Drive Glen Allen, VA 23060</p>	Revision Description: Add new parts		Revision Date: 7/18/14		Approved by: DOC4996	
	Request Number:		Page: 1 of 5		Document #: 540006300	
	Issue Code(s): L				Rev: C	

## Parts and Accessories Diagram

### Model HBB250R

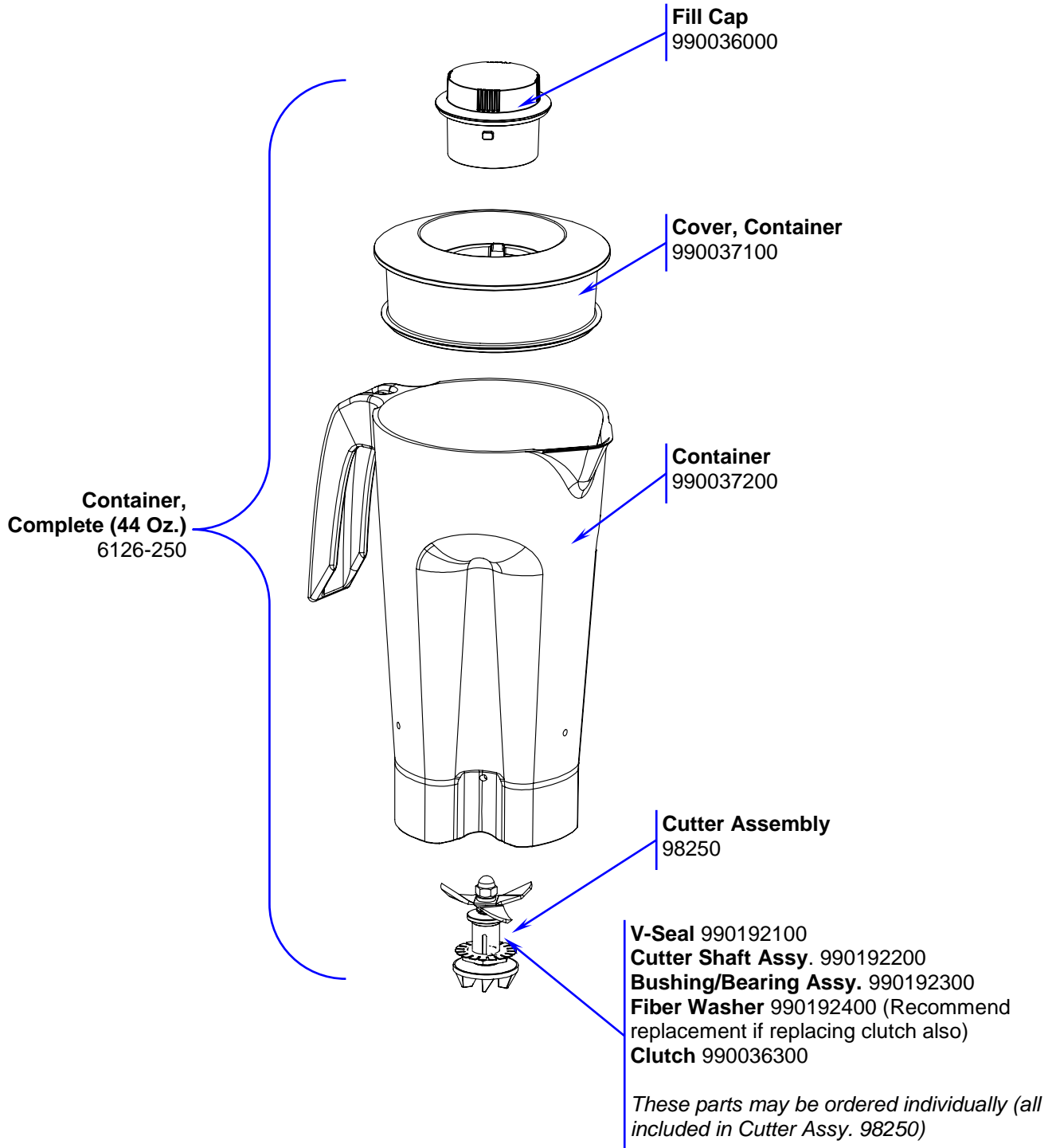
**PROPRIETARY RIGHTS NOTICE** This document and all information contained within it is the property of Hamilton Beach Brands, Inc. (HBB). It is confidential and proprietary and has been provided to you for a limited purpose. It must be returned or destroyed upon request. Disclosure, reproduction or use of this document and any information contained within it, in full or in part, for any purpose is forbidden without the prior written consent of HBB. No photographs may be taken of any article fabricated or assembled from this document without the prior written consent of HBB.



 Hamilton Beach 4421 Waterfront Drive Glen Allen, VA 23060	Revision Description: Add new parts		Revision Date: 7/18/14		Approved by: DOC4996	
	Request Number:		Page: 2 of 5	Document #:	540006300	Rev: C
	Issue Code(s):	L				

## Parts and Accessories Diagram

### Model HBB250R

**PROPRIETARY RIGHTS NOTICE** This document and all information contained within it is the property of Hamilton Beach Brands, Inc. (HBB). It is confidential and proprietary and has been provided to you for a limited purpose. It must be returned or destroyed upon request. Disclosure, reproduction or use of this document and any information contained within it, in full or in part, for any purpose is forbidden without the prior written consent of HBB. No photographs may be taken of any article fabricated or assembled from this document without the prior written consent of HBB.

## Accessories

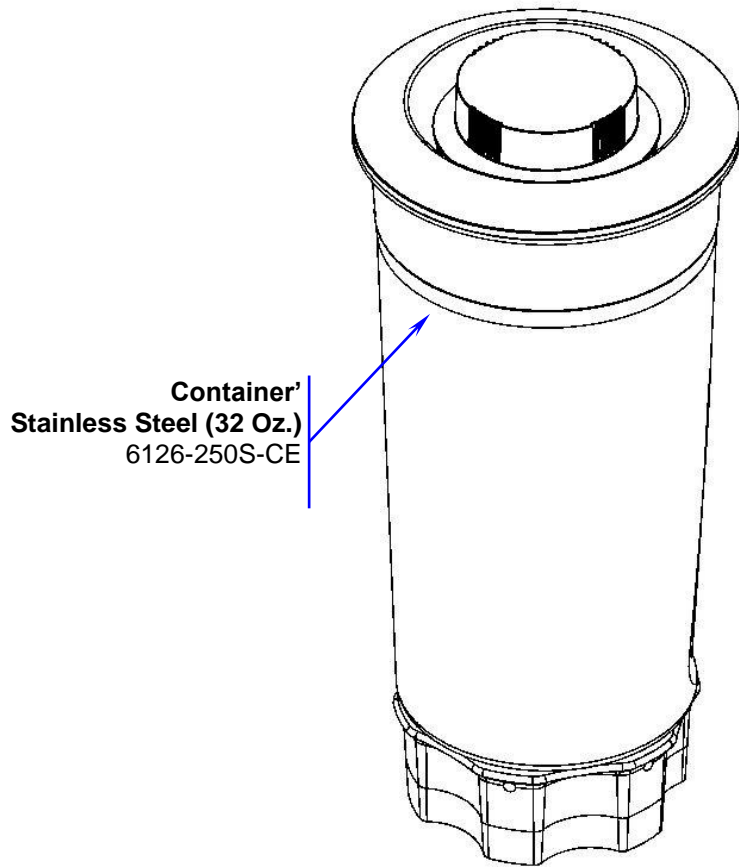

Container Washer  
BCR100

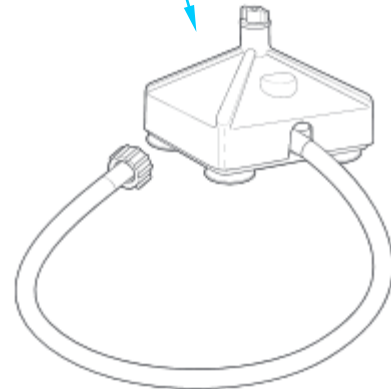

<b>Hamilton Beach</b> 4421 Waterfront Drive Glen Allen, VA 23060	Revision Description: Add new parts							
	Request Number:		Revision Date:	7/18/14	Approved by:	DOC4996		
	Issue Code(s):	L	Page:	3 of 5	Document #:	540006300	Rev:	C

## Parts and Accessories Diagram

### Model HBB250R

**PROPRIETARY RIGHTS NOTICE** This document and all information contained within it is the property of Hamilton Beach Brands, Inc. (HBB). It is confidential and proprietary and has been provided to you for a limited purpose. It must be returned or destroyed upon request. Disclosure, reproduction or use of this document and any information contained within it, in full or in part, for any purpose is forbidden without the prior written consent of HBB. No photographs may be taken of any article fabricated or assembled from this document without the prior written consent of HBB.

### Cutter Assembly Replacement Instructions

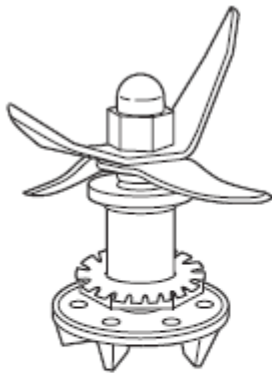

**Cutter Repair Kit  
for Rio Blenders**



#### **⚠ WARNING**



**Cut Hazard**  
Handle cutter  
assembly with  
care.  
Failure to follow  
these instructions  
can result in cuts  
or other injuries.

#### **Removing the old cutter assembly**

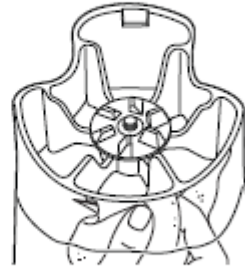

Hold the blades with a cloth. Unscrew the clutch counterclockwise.



Remove the clutch and felt washer.



Remove the shaft and blade assembly

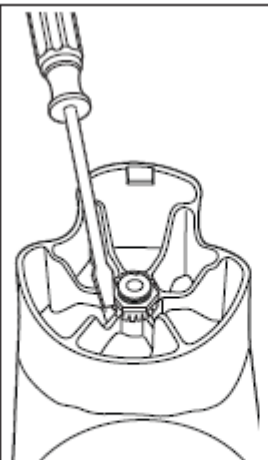

Use a flathead screwdriver to flatten the tabs on the tab washer.



Remove the nut by turning counterclockwise by hand. Then remove the tab washer and pressure washer.

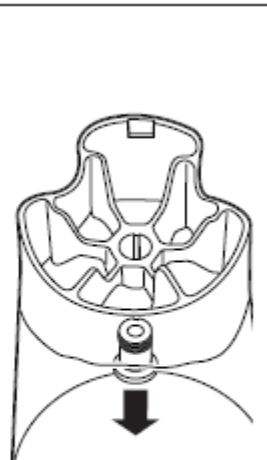

Remove bushing.

<p>4421 Waterfront Drive Glen Allen, VA 23060</p>	Revision Description: Add new parts		Revision Date: 7/18/14		Approved by: DOC4996	
	Request Number:		Page: 4 of 5		Document #: 540006300	
	Issue Code(s): L		Rev: C			

## Parts and Accessories Diagram

### Model HBB250R

**PROPRIETARY RIGHTS NOTICE** This document and all information contained within it is the property of Hamilton Beach Brands, Inc. (HBB). It is confidential and proprietary and has been provided to you for a limited purpose. It must be returned or destroyed upon request. Disclosure, reproduction or use of this document and any information contained within it, in full or in part, for any purpose is forbidden without the prior written consent of HBB. No photographs may be taken of any article fabricated or assembled from this document without the prior written consent of HBB.

**Installing the new cutter assembly**



Hold the blades with a cloth. Unscrew the clutch counterclockwise.



Disassemble the new cutter assembly.

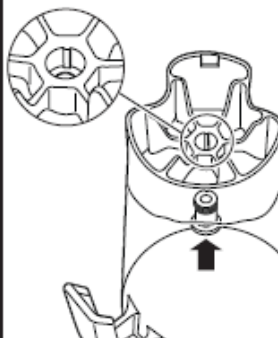

Align the groove in the bushing with the rib on the pitcher and press into place from inside the pitcher.

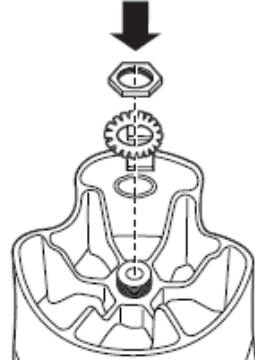

Install the pressure washer, tab washer, and retainer nut by hand. Do NOT overtighten the retainer nut!

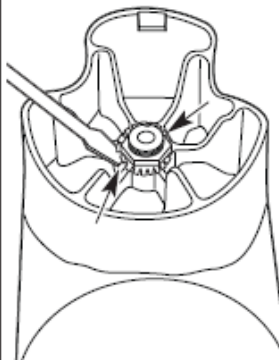

Use a flathead screwdriver to bend up two opposing tabs on the tab washer.

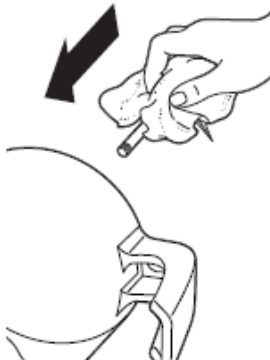

Install the shaft and blades



Install the felt washer and clutch.



Tighten the clutch by turning it clockwise while holding the blades with a cloth.

 4421 Waterfront Drive Glen Allen, VA 23060	Revision Description: Add new parts		Revision Date: 7/18/14		Approved by: DOC4996	
	Request Number:		Page: 5 of 5		Document #: 540006300	
	Issue Code(s): L				Rev: C	